

EDEN CLOUD ERGO CHAIR

DISASSEMBLY AND RECYCLING INSTRUCTIONS

EDEN



Eden Cloud Ergo with Arms

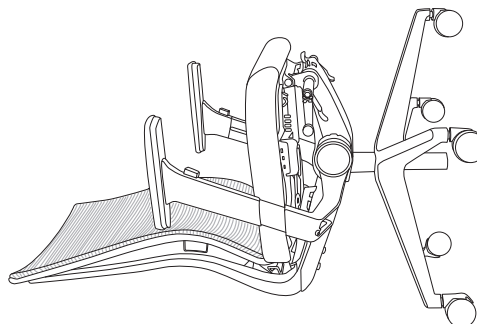

1

Lay chair on back.

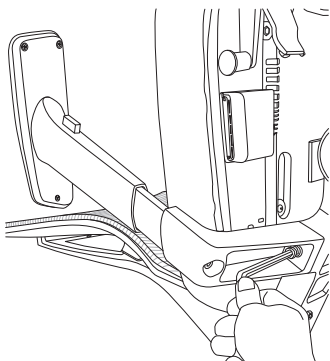

2

If your chair has arms: using 6mm Allen Key remove the bolt attaching arm bracket to main chair frame. Repeat with other side.

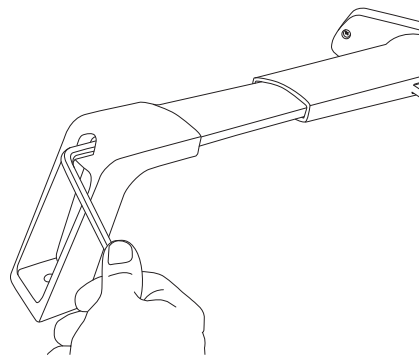

3

Using 6mm Allen Key remove bolt attaching arm bracket to arm upright. Repeat with other arm.

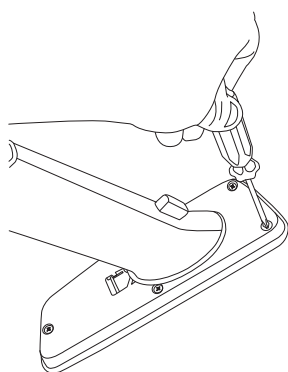

4

Using Pozi drive screwdriver remove 5 screws holding arm pad to armrest.

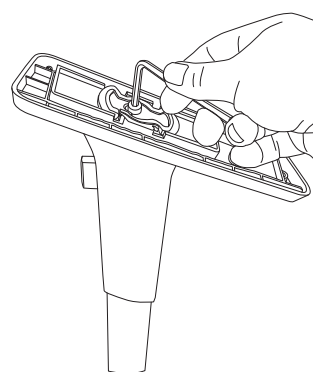

5

Using 5mm Allen Key remove 2 bolts holding armrest to arm upright.

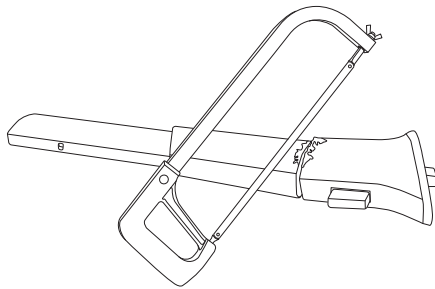

6

Using a bandsaw or hacksaw cut through plastic arm upright approximately halfway from top. Slide plastic upright off steel upright.

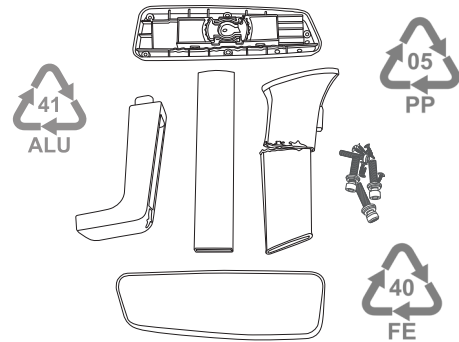

7

Recycle 3 plastic arm parts.
Recycle arm brackets
Recycle arm upright and fasteners.

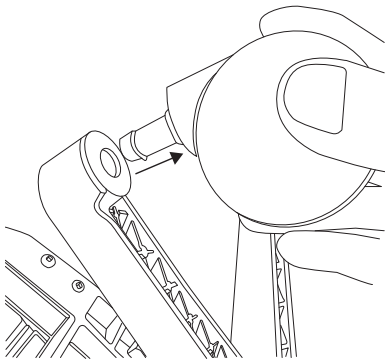

8

Pull castors out of base.

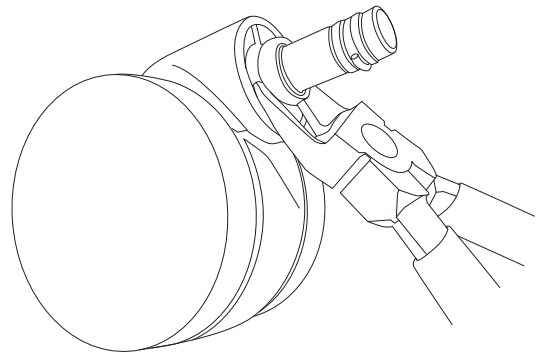

9

Pull out castor stem with pliers. Pry off castor wheels with screwdriver. Pull out castor axle with pliers.

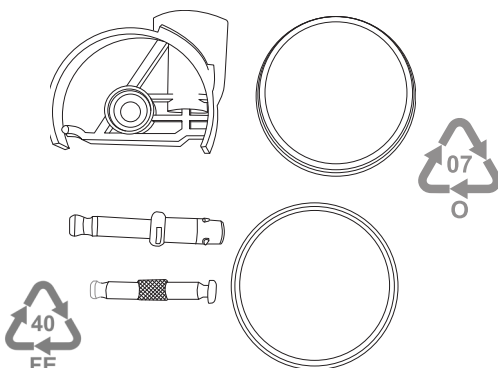

10

Recycle castor body and wheels.
Recycle castor axle and stem.

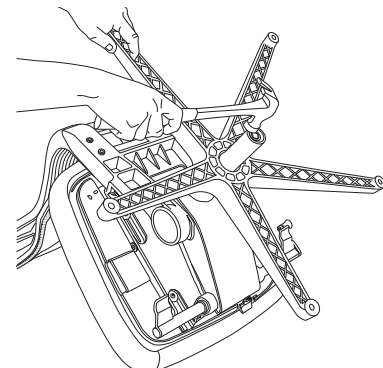

11

Strike bottom of gaslift firmly with a hammer until base separates from gaslift.

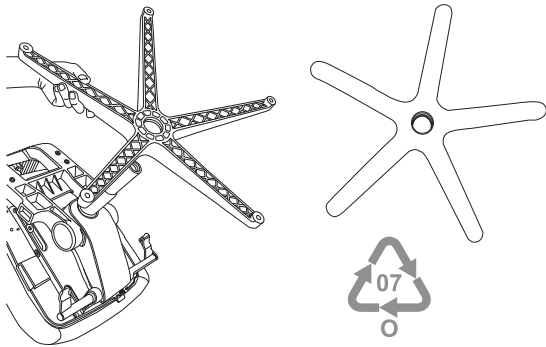

12

Recycle base.

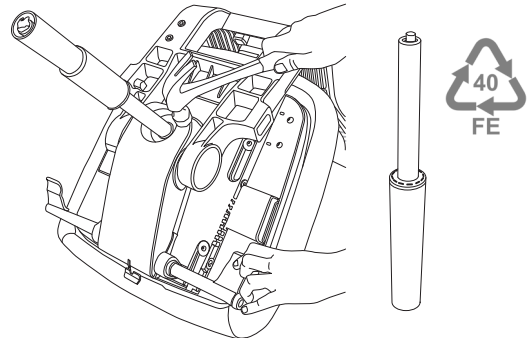

13

To remove the gaslift - depress the gaslift lever and strike the mechanism close to where the gaslift inserts.
Recycle gaslift.

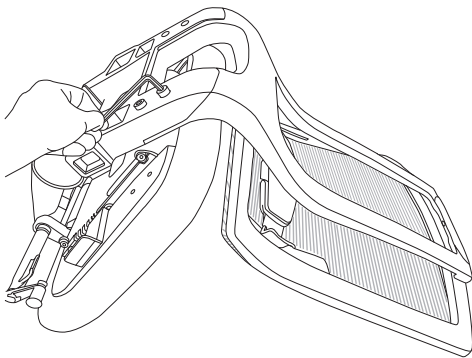

14

Separate the back frame from the seat by removing 4 bolts with a 6mm Allen Key.

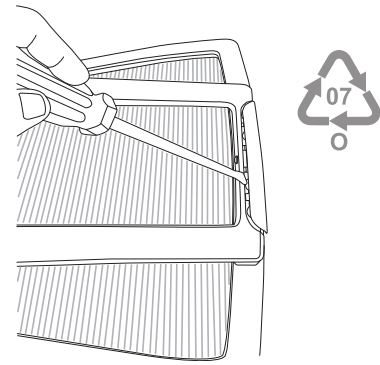

15

Using flat blade screwdriver pry off screw cover at top of back.
Recycle screw cover.

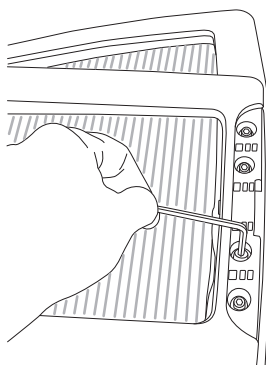

16

Using 5mm Allen Key remove 4 bolts that attach top of back to the back frame.

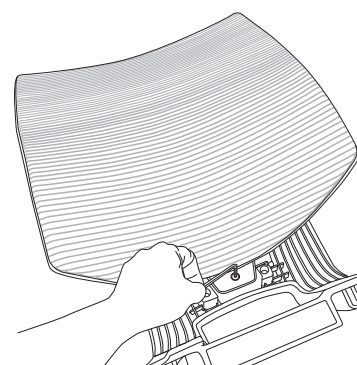

17

Using 5mm Allen Key remove the bolt that holds bottom of back to the back frame.

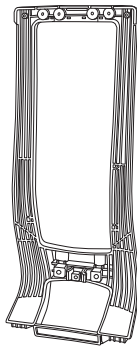

18

Recycle back frame.

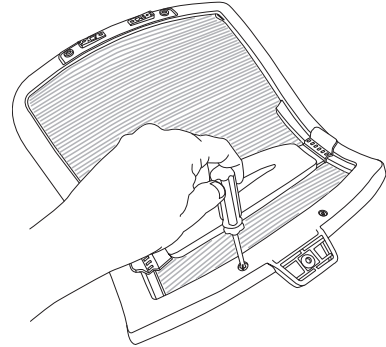

19

Using Pozi drive screwdriver remove 2 screws at bottom of back outer.

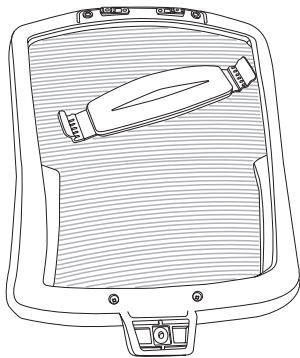

20

Slide lumbar support up channel until it is removed. Dispose of lumbar support.

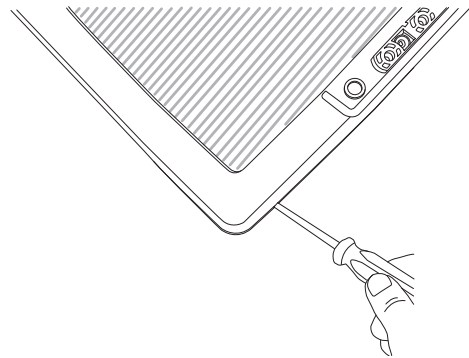

21

Using a flat blade screwdriver pry back outer from back inner.

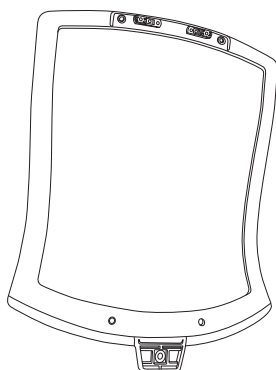

22

Recycle back outer.

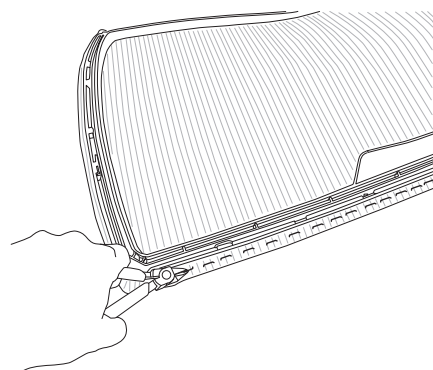

23

Remove staples holding back mesh to back inner. Dispose of staples.

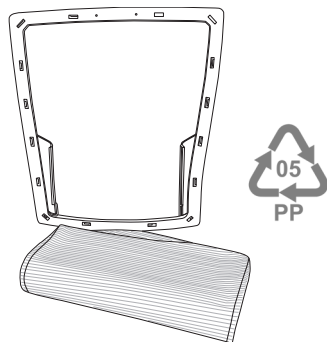

24

Dispose of back mesh.
Recycle back inner.

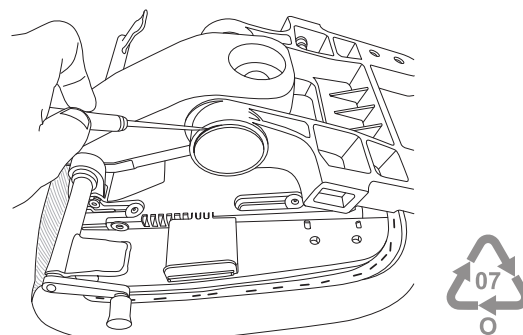

25

Using a flat blade screwdriver pry off the plastic cover on the mechanism pivot point. Repeat on other side.
Recycle plastic cover.

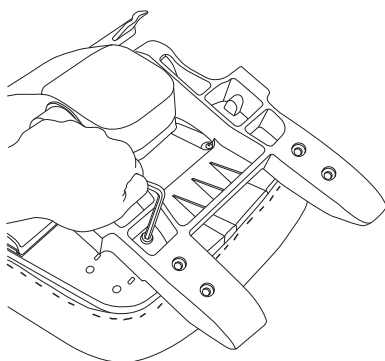

26

Using 6mm Allen Key remove 2 bolts that hold main chair frame to seat pan.

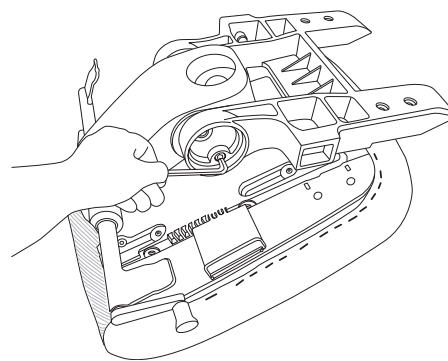

27

Using 6mm Allen Key remove bolt that holds main chair frame to mechanism. Repeat on other side.

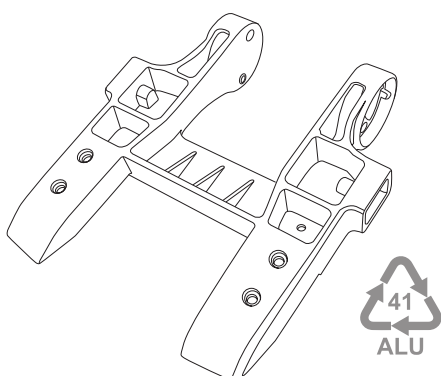

28

Recycle main chair frame.

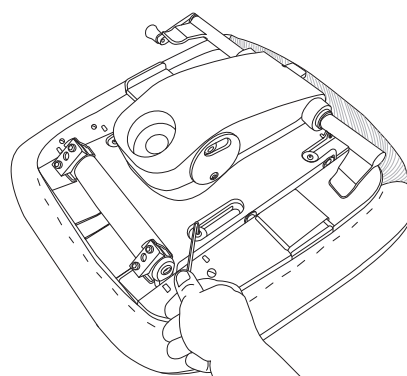

29

Using 5mm Allen Key remove 4 bolts holding mechanism to seat pan.
Separate mechanism from seat pan.

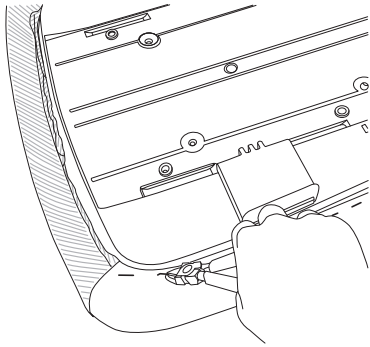

30

Using slotted screwdriver remove staples attaching fabric to seat pan.
Dispose of seat fabric, foam and staples.

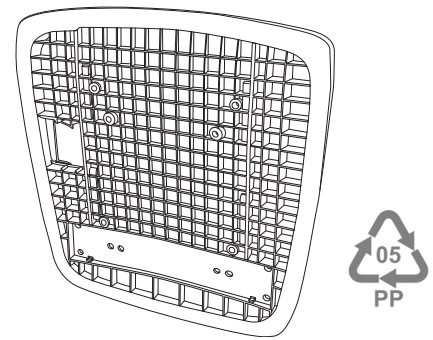

31

Recycle seat pan.

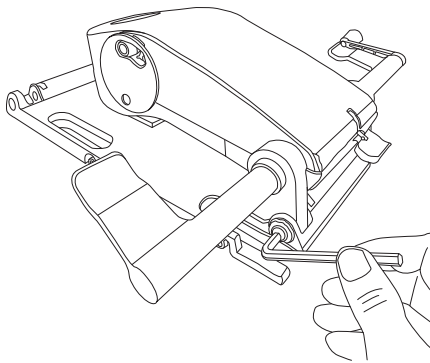

32

Using 6mm Allen Key remove bolt holding mechanism to seat slide plate. Repeat on other side.



33

Recycle seat slide plate.

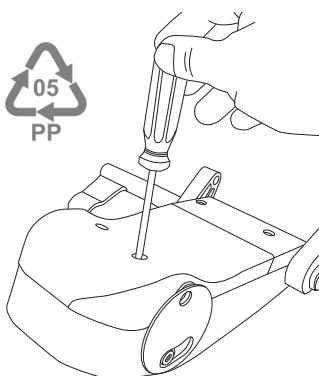

34

Using Pozi screwdriver remove 2 screws that hold plastic mechanism cover in place.
Recycle mechanism cover.

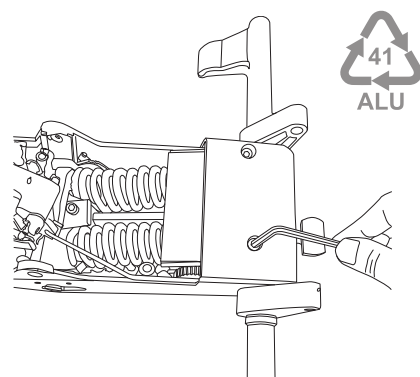

35

Using a 5mm Allen Key remove 2 bolts that hold aluminium cover on mechanism.
Recycle cover.

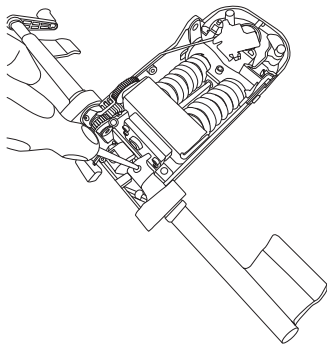

36

Using Pozi screwdriver remove 2 screws that attach handles to mechanism.

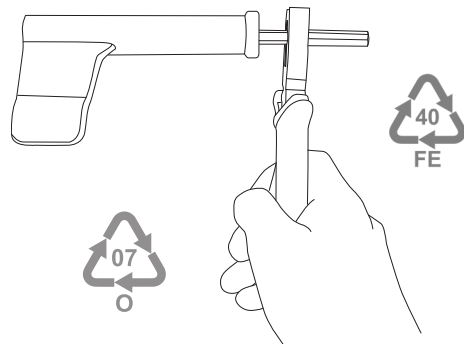

37

Using pliers remove plastic handle from steel shafts. Repeat with the other handle.

Recycle plastic handles.

Recycle steel shafts.

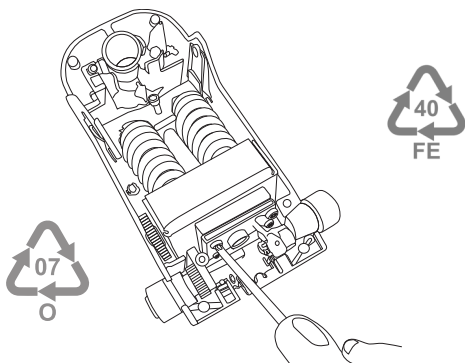

38

Using 5mm Allen Key and Pozi screwdriver remove 1 bolt and 4 screws holding mechanism components in place.

Recycle steel plates and springs.

Recycle nylon gears and blocks.

Recycle aluminium lever & mechanism body.

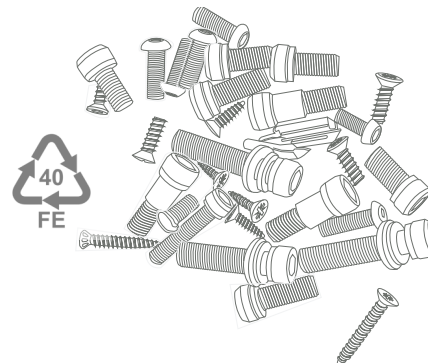

39

Recycle fasteners.